

IN3900 (SERIES)

InFocus
Bright Ideas Made Brilliant



Instant Impact

Display Flexibility - Intuitive Functionality
Wireless Interactivity - Expanded Connectivity

IN3900 (SERIES)

Design Meets Function

The InFocus IN3900 DLP® projector series provides the ultimate flexible display solution for small-to-medium meeting rooms, conference rooms, or classrooms. This series is equipped with signature InFocus features such as DisplayLink™, our content over USB 2.0 solution, which allows users to set-up in seconds. The IN3900 series also has LitePort™ which allows for PC-Free presentations from any standard USB drive, and is wireless capable with the optional LiteShow II™. Above all, the IN3900 series is compatible with LiteBoard, our newest feature which empowers users to wirelessly interact, annotate and highlight displayed information with a wireless wand. The IN3900 series is perfect for users looking to make an impact with the best in ease-of-use technology and superior image quality.

IN3902

XGA (1024 x 768) Resolution
3000 Lumens
Full Connectivity and LiteBoard Ready
Low Power Consumption

The InFocus IN3902 is an ideal option for applications that require standard resolution, crisp pictures, ease-of-use, and an interactive platform all-in-one.

IN3904

WXGA (1280 x 800) Resolution
3000 Lumens
Full Connectivity and LiteBoard Ready
Low Power Consumption

The InFocus IN3904 brings reliable InFocus quality and ease-of-use, with expanded connectivity and a LiteBoard Ready option to wide format presentations.



"This series was developed with networking, full connectivity and ease of use in mind, plus it has our latest interactive technology called LiteBoard. This series truly enables collaboration."

Robert Detwiler
InFocus Product Manager



FREE!
LiteBoard
Wand Kit
Limited Time Offer

Projector Management

Control at your fingertips. The IN3900 series built-in web browser allows network administrators to remotely access and control the projector over standard LAN/WAN. The series is compatible with ProjectorNet 3.0, our free asset management software that enables you to conserve projector lamp life by scheduling On/Off times, and presetting maintenance events and anti-theft security alerts.

LiteBoard Ready

Bring another dimension to your flat presentations. LiteBoard™ is a built-in interactive solution for your digitally projected content. Combine any of our LiteBoard Ready projectors with the optional LiteBoard Wand Kit, and turn any surface into a collaborative workspace. The LiteBoard Wand wirelessly interacts with InFocus LiteBoard Ready projectors, allowing users to annotate, append, and highlight projected content. No calibration or proprietary software is needed - just connect, project and collaborate.



Touch

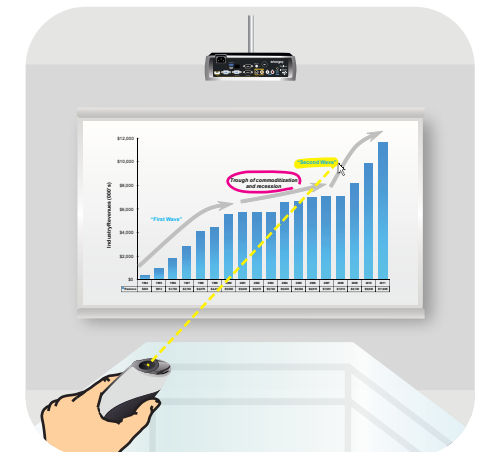

Away

24/7 Non-Stop Projection

All InFocus DLP projectors are filter-free and are rated for 24/7 fail-safe operation, resulting in less maintenance and hours of worry-free use.

Rich Connectivity

The IN3900 series features standard analog VGA connectivity along with HDMI 1.3 for the latest in Computer and HD Video connectivity. Engineered to be Wireless-Ready with LiteShow II, the IN3900 series also includes embedded networking and RS232 control for full projector management over any network.

Dynamic Messaging System

Send dynamic messages for instant display to InFocus projectors using the InFocus Dynamic Messaging System (DMS). Perfect for general and important announcements such as schedule changes, weather warnings, breaking news and emergency notifications.

LitePort PC-Free Presentations

The IN3900 features LitePort, an embedded PC-free JPEG Reader that enables users to project images directly from a standard USB flash drive – no computer needed.

LiteTouch Touchsense Keypad

The sleek backlit LiteTouch control panel provides one-touch access to the most commonly used projector functions.

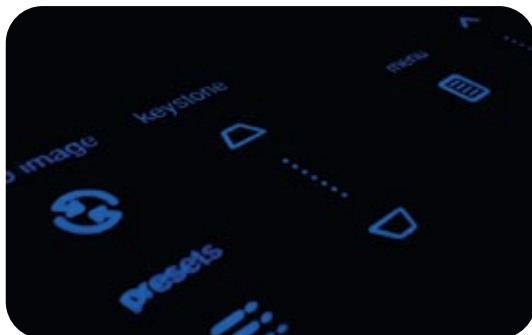

LiteShow II

The optional InFocus LiteShow II wireless adapter connects personal computers to InFocus digital projectors wirelessly. The high bandwidth 802.11 b/g connection supports simultaneous transmission of audio along with video/data content, providing a completely wireless multimedia presentation.

DisplayLink Connectivity

Hassle-free, lightning fast-projection. DisplayLink Content over USB technology eliminates the need for bulky VGA cables and allows for computer and image set up in seconds without toggling or cumbersome function key combinations. DisplayLink makes projecting simple!

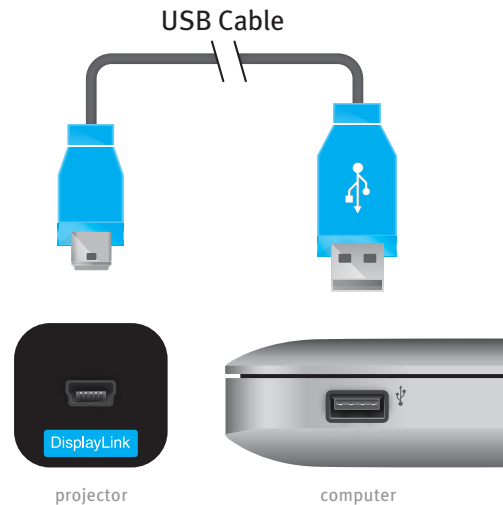

Digital, Brilliant Colour

The IN3900 series delivers vivid true-to-life colours with DLP technology and the InFocus BrilliantColor™ enhancement.

Intuitive and Easy to Use Interface

Over 20 years of customer feedback has gone into designing the IN3900 series' best-in-class menu system. It is easy to navigate, has 17 standard languages and a unique intuitive flow.

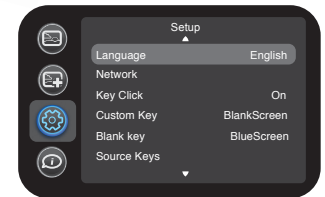

High Resolution XGA/WXGA

Designed for optimal flexibility, the IN3900 series is available in widescreen WXGA (1280 x 800) resolution to match the new wide format standard in personal computers and video content, or XGA (1024 x 768) resolution for legacy applications.



XGA
1,024 x 768 PIXELS

WXGA
1,280 x 800 PIXELS



Specifications*

Optional Accessories

- Alternate Remote (HW-COMMANDER)
- Alternate Remote (HW-PRESENTER-RF-R)
- Cables & Adapters
- LiteShow II (INLITESHOW2)
- LiteBoard Wand Kit (HW-LBWAND-oo) includes:
 - Wand
 - Power Supply
 - USB Cable

- Replacement Lamp (SP-LAMP-041)
- Universal Ceiling Mount (SP-CEIL-UNIV)

For more information, please visit:
www.infocus.com/Accessories.aspx

Warranty

Providing the highest quality products and support is very important to InFocus. The IN3900 series digital projectors come standard with a 5 year limited factory warranty (including parts¹ and labour²) a 1 year limited lamp replacement warranty and 5 year DLP warranty. Extended product and lamp warranty programs are also available.

For more information, please visit:
www.infocus.com/Support/Warranty.aspx

IN3900 (SERIES) FEATURES

- Auto Keystone
- BrilliantColor
- Closed Captioning
- DisplayLink Plug & Play
- Dynamic Messaging System (DMS)
- Freeze Frame with Magnifying Function
- HDMI 1.3
- InFocus User Interface
- Lamp Door On Top
- LiteBoard Ready
- LitePort USB JPEG Player
- LiteSwitch Instant On/Off
- LiteShow II Wireless Ready
- LiteTouch Touchsense Keypad
- Logo Capture
- Low Power Standby (<1W)
- ProjectorNet Web Browser Control
- SNMP Capable
- Sleep Timer



InFocus
Bright Ideas Made Brilliant

www.infocus.com

INFOCUS CORPORATE HEADQUARTERS
 13190 SW 68th Parkway
 Portland, Oregon 97223-8368, USA
 Phone: (1) 503-207-4700
 Toll Free: (1) 877-388-8385
 Fax: (1) 503-207-1937

INTERNATIONAL HEADQUARTERS
 1 Fullerton Road
 One Fullerton
 Singapore 049213
 Phone: (65) 6513-9600
 Fax: (65) 6238-0535



LiteBoard™
ready



©2009 InFocus Corporation. All rights reserved. Specifications are subject to change without further notice. InFocus and InFocus Bright Ideas Made Brilliant are either trademarks or registered trademarks of InFocus Corporation in the United States and other countries. DLP, the DLP logo, and the DLP medallion are trademarks of Texas Instruments. All trademarks are used with permission or are for identification purposes only and are the property of their respective companies.
¹Excludes power supply, fans, colour wheel and light tunnel which are covered for three (3) years.
²Labour is covered for three (3) years from date of proof of purchase.
 InFocus_IN3900_DS_EU_18DEC09. Part Number: MMINFOCUS-0204

	IN3902	IN3904
Native Resolution	IN3902 – XGA 1024 × 768 IN3904 – WXGA 1280 × 800	
Maximum Resolution	WUXGA (1920 × 1200)	
Display Technology - DMD	IN3902 – DLP .55" XGA IN3904 – DLP .65" WXGA	
Brightness	3000 ANSI lm, (2400 lm Eco Mode)	
Lamp Life**	4000 Hrs Eco Mode (3000 Hrs Normal)	
Contrast Ratio	2000:1 Typical	
Audible Noise	28 db Eco Mode (33 db High Power)	
Computer Compatibility	PC, MAC	
Keystone Correction	Automatic, +/-30 degrees	
Number of Colours	16.7 Million, True Colour	
Aspect Ratio	IN3902 – Native 4:3 (5:4, 16:9, 16:10 Supported) IN3904 – Native 16:10 (4:3, 5:4, 16:9 Supported)	
Lamp Power	238 W Eco Mode (298 W Normal), <1 W (Standby Mode)	
Power Supply	100 – 240 Vac, 50/60 Hz	
Zoom Ratio	1.1:1	
Throw Ratio	IN3902 – 1.95 – 2.15 IN3904 – 1.56 – 1.72	
Video Compatibility	NTSC / NTSC4.43 / PAL / PAL-M / PAL-N / SECAM SDTV: 480i, 576i EDTV: 480p, 576p HDTV: 720p, 1080i, 1080p	
Audio	2 × 3 W mono	
Input Sources	2 × D-sub HD15, S-Video, Composite Video DisplayLink, HDMI 1.3, LitePort 4 × assignable audio in (3.5 mm & R/L, HDMI, DisplayLink)	
Projection Distance	IN3902 – 6.39 ft – 36.15 ft / 1.95 m – 11.02 m IN3904 – 5.11 ft – 36.15 ft / 1.56 m – 11.02 m	
Projection Methods	Front, Rear, Ceiling Front, Ceiling Rear	
Product Weight	7 lbs / 3.17 kg	
Product Dimensions - W×D×H	12.4 × 9.8 × 3.7 in / 315 × 249 × 94 mm	
Product Colour	Black and Silver	
Shipping Dimension - W×D×H	18.8 × 8.8 × 13.1 in / 477 × 223 × 332 mm	
Shipping Weight	14.3 lbs / 6.48 kg	
Maximum Altitude	10,000 ft / 3,000 m	
Remote Control	Navigator - 2	
Ships With - Accessories	Remote, VGA Cable, Power Cord, USB cable, Carry Case, Safety Instruction, Projector User's Guide, DisplayLink User's Guide	
Menu Languages	English, French, German, Italian, Korean, Norwegian, Portuguese, Russian, Spanish, Traditional Chinese, Simplified Chinese, Swedish, Finnish, Danish, Dutch, Polish, Turkish	
Lamp (particle) Containment	Tested to contain particles larger than 0.8 mm ***	
Accessories Warranty	90 days	
Approvals	C-Tick (Australia), CE (Europe), UL & CUL (USA & Canada), FCC (USA), IRAM (Argentina), MIC & eK (South Korea), CCC (China), PSB (Singapore)	
Security	Kensington Lock	
DisplayLink Operating System	Windows® XP, Windows Vista, MAC® OS X	
System Requirements	Windows: 1.2GHz CPU and 512MB memory MAC: Apple Intel OS X 10.4.11 or higher	
DisplayLink Max Resolution	4:3 (1400 × 1050) 16:10 (1140 × 900)	

* Product specifications, terms, and offerings are subject to change at any time without notice.
 ** Actual lamp life may vary based on the ambient environment and projector usage. Conditions that may affect lamp life include temperature, altitude, and rapidly switching the projector on and off.
 *** Tested to contain particles larger than the specified size in any dimension