

# SP8602

**InFocus**  
Bright Ideas Made Brilliant



## Next Generation Home Cinema

Ease of Use - Sophisticated Features  
Elegant Styling - Stunning Image Quality

# SP8602

## Introducing the next generation of ScreenPlay Home Cinema

The InFocus ScreenPlay 8602 combines rich styling, stunning imagery, full features, and connectivity into an award-winning HD home cinema projector that creates a truly immersive cinema experience. It features DLP® DarkChip™ technology with cutting edge InFocus BrilliantColor™ implementation and native 1080P resolution. The SP8602 offers 30,000:1 contrast ratio, high-performance optics, and the latest in high-definition connectivity to display high-resolution images and video content in vivid colors with outstanding depth and detail. With the InFocus SP8602, you will never miss a thing.

### It's all in the details

Even the most minute detail yields maximum impact. The InFocus SP8602 features DLP DarkChip technology with InFocus BrilliantColor implementation and video-optimized 1400 lumens for stunning clarity, color, and vibrancy, recreating true cinematic experience in high definition 1080P resolution with astounding realism. Discover the thrill of larger-than-life home entertainment with a system that raises your adrenaline and makes you a player in the game.

### Real blacks, amazingly bright colors

The SP8602 delivers the deepest blacks and brightest, most vibrant colors even with the lights on. Dynamic Black and the latest DarkChip Technology deliver 30,000:1 maximum contrast, distinguishing varying shades of blacks with razor-sharp accuracy while giving the same intuitive discrimination in displaying colorful images. Digital Gamma correction and Variable Color adjustment uses a range of 1.07 billion colors and a 6-segment color wheel—capturing life's diverse hues and textures, and projecting them into your home.

### Ultra-smooth playback

Using Pixelworks DNX™ 10-bit video processing, the SP8602's outstanding processing, de-interlacing, and advanced scaling delivers ultra-smooth playback of film and video content. It uses a proprietary motion engine that allows for faster, more fluid transition between frames in moving images. Fast color refresh provides color stability and superb motion quality, further enhancing the viewing experience.

### Get the best seat in the house

The SP8602 features vertical and horizontal lens shifts that can beam an image of up to 300 inches from anywhere in the room and still project a perfect picture onscreen. Automatic ceiling detection will flip the image when necessary, and image warping allows for adjusting images on imperfect surfaces, giving you crisp, square images every time.

*“The InFocus ScreenPlay 8602 is a blockbuster hit blending rich styling, full features and stunning image quality into an award winning home cinema HD projector”.*

**Benjamin Joy**  
InFocus Product Director



### Choose Your Color

The SP8602's outer design offers you the option of interchangeable skins to match your décor. Choose from Matte Black, Matte White, Glossy Black, Walnut, or even a pre-primed set for custom installations.

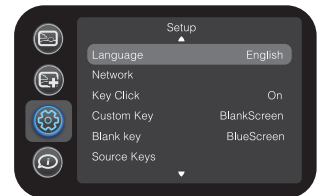

InFocus Interface



Unique Cable Management System



### Digital, Brilliant Color

The SP8602 delivers a stunning combination of HD resolution and vivid detail in true-to-life colors using DLP DarkChip technology with the InFocus BrilliantColor enhancement. For lasting brightness and color that stays.

### Rich Connectivity Flexibility

The SP8602 uses the latest in high-definition connectivity, providing a complete suite of analog and digital connectivity, including an onboard HDMI 1.3 DeepColor support for the ultimate in installation flexibility.

### Unique "Blue Iris" Glow Ring

The exclusive InFocus "Blue Iris" glow ring notifies users – from experienced to novice, when the projector is powering up or down. No more guessing the status of the projector.

### Intuitive and Easy to Use Interface

Over 20 years of customer feedback has gone into designing the SP8602 best-in-class menu system. It is easy to navigate, has 17 standard languages and a unique intuitive flow.

### Unique Cable Management System

The integrated cable management system provides easy access to the rich connector panel, aligning each cable to the cable router, keeping them organized and out of sight. The result: 100% hidden cables that look as good as the rest of your room.

### LiteTouch™ Keypad

The sleek backlit LiteTouch control panel provides one-touch access to the most commonly used projector functions.



InFocus LiteTouch Keypad





## Optional Accessories

Projection Screens  
Cables & Adaptors  
Security Lock (SEC-LOCK-01)  
Replacement Lamp (SP-LAMP-054)  
LiteShow II™ Wireless Adapter (INLITESHOW2)  
Ceiling Mount (SP-CEIL-INSTALL)  
Black Skin Kit (TOP-03-GB)  
Matte White Skin Kit (TOP-03-MW)  
Walnut Skin Kit (TOP-03-W)  
Primer Skin Kit (TOP-03-B)

For more information, please visit:  
[www.infocus.com/Accessories.aspx](http://www.infocus.com/Accessories.aspx)



## Warranty

Providing the highest quality products and support is very important to InFocus. The new SP8602 digital projectors come standard with a 5 year limited factory warranty (including parts<sup>1</sup> and labor<sup>2</sup>) a 6 month limited lamp replacement warranty and 5 year DLP warranty. Extended product and lamp warranty programs are also available.

For more information, please visit:  
[www.infocus.com/Support/Warranty.aspx](http://www.infocus.com/Support/Warranty.aspx)



## SP8602 FEATURES

- 4x/6x Color Refresh Rate
- 2-3 Pull Down
- BrilliantColor
- Cable Management System
- Ceiling Mount
- Custom Skins
- Digital Gamma Correction
- Electrical H&V Keystone Correction
- Flesh Tone Correction
- Freeze Frame with Magnifying Function
- Full 2.35 Cinemascope Support
- InFocus UI
- ISF Presets
- Lamp Door on Side
- Low Power Standby (<1W)
- LiteTouch Touchsense Keypad
- Motion Smoothing
- Pincushion/Barrel Distortion Correction
- Sleep Timer
- SplitScreen™ Dual Images



**InFocus**  
Bright Ideas Made Brilliant

[www.infocus.com](http://www.infocus.com)

**INFOCUS CORPORATE HEADQUARTERS**  
13190 SW 68th Parkway  
Portland, Oregon 97223-8368, USA  
Phone: (1) 503-207-4700  
Toll Free: (1) 877-388-8385  
Fax: (1) 503-207-1937

**INTERNATIONAL HEADQUARTERS**  
1 Fullerton Road  
One Fullerton  
Singapore 049213  
Phone: (65) 6513-9600  
Fax: (65) 6238-0535

©2009 InFocus Corporation. All rights reserved. Specifications are subject to change without further notice. InFocus and InFocus Bright Ideas Made Brilliant are either trademarks or registered trademarks of InFocus Corporation in the United States and other countries. DLP, the DLP logo, and the DLP medallion are trademarks of Texas Instruments. All trademarks are used with permission or are for identification purposes only and are the property of their respective companies.  
<sup>1</sup>Excludes power supply, fans, color wheel and light tunnel which are covered for two (2) years.  
<sup>2</sup>Labor is covered for two (2) years from date of proof of purchase.  
InFocus\_SP8602\_DS\_EN\_10JAN10. Part Number: MMINFOCUS-0204

# Specifications\*

Specifications*	SP8602
Native Resolution	1920 × 1080 (1080P)
Maximum Resolution	WUXGA (1920 × 1200)
Display Technology - DMD	DLP .65" 1080p DarkChip w/Brilliant Color
Brightness	1300 Video Lumens (Optimized for REC 709 Video)
Lamp Life**	2500 Hrs Eco Mode (2000 Hrs Normal)
Contrast Ratio - Full On/Full Off	5000:1 Native
Contrast Ratio Dynamic Black	30,000:1 Max
Audible Noise	28 db Eco Mode (29 db High Power)
Computer Compatibility	PC, MAC
Lenses (Std) - Focal Length	22.18 mm at f2.45 ~ 33.27 mm at f2.9
- Throw Ratio	1.494 ~ 2.279
- Zoom Ratio	1.5
- Focus Range	1.5 m ~ 10 m
Lens Shift Type	Manual
Lens Shift - Vertical	+5% to +30%
- Horizontal	+/- 15% at 105% Vertical Offset
Colorwheel	RGBRGB / 6 Segment
Number of Colors	10 Bit/Color 1.07 Billion Colors
Aspect Ratio	Native 16:9 (5:4, 4:3, 16:10 Supported)
Lamp Power	260 Watt
Zoom/Focus	Manual Focus Manual Zoom
Synch - Horizontal Scan Freq	15 ~ 100kHz (Video/PC)
- Vertical Scan Freq	50 ~ 85Hz (Video/PC)
Video Compatibility	NTSC / PAL / SECAM / PAL-M, N / NTSC4.43 SDTV: 480i, 480p, 576i, 576p HDTV: 720p, 1080i, 1080p (60,30,24Hz)
Input Sources	15pin Dsub (VGA), HDMI 1.3 DeepColor Support × 2, Component × 3, S-Video × 1, Composite × 1
Control	RS232 Dsub-9, USB Type B
Screen Trigger	3.5 mm Mini × 3, 12 VDC 250 ma
Wired IR	3.5 mm Stereo Mini Following Xantech Standard
Product Weight	16.76 lbs / 7.6 kg
Product Dimensions - W×D×H	14.25 × 21.25 × 7.0 in / 362 × 540 × 178 mm
Product Color	Matte Black, Glossy Black, Matte White, Walnut, Primer for Customization
Shipping Dimension - W×D×H	27.5 × 19.5 × 12.32 in / 699 × 495 × 313 mm
Shipping Weight	28.3 lbs / 12.8 kg
Maximum Altitude	7,500 ft / 2286 m
Remote Control	Director - 2
Design	InFocus 2009 ID
Ships with - Accessories	HDMI Cable (2.5 m), Power Cord (2.5 m), Remote, Projector User's Guide
Menu Languages	English, French, German, Italian, Korean, Portuguese, Russian, Spanish, Traditional Chinese, Simplified Chinese, Norwegian, Swedish, Finnish, Danish, Dutch, Polish, Turkish
Lamp Rupture Containment	Tested to larger than 0.8 mm ***
Accessories Warranty	90 days
Regulatory Model	H8300
Approvals	UL60950-1/cUL (USA and Canada), FCC Part 15, Class B (USA), CE (Europe), S-Mark (Argentina), GOST (Russia), KC (Korea), Safety Mark (Singapore), CCC, CECP (China), C-Tick (Australia/NZ) Cable Lock
Security	

\* Product specifications, terms, and offerings are subject to change at any time without notice.

\*\* Actual lamp life may vary based on the ambient environment and projector usage. Conditions that may affect lamp life include temperature, altitude, and rapidly switching the projector on and off.

\*\*\* Tested to contain particles larger than the specified size in any dimension



**InFocus**  
ScreenPlay



**HDMI**  
HIGH-DEFINITION MULTIMEDIA INTERFACE